

Pipe Hanger

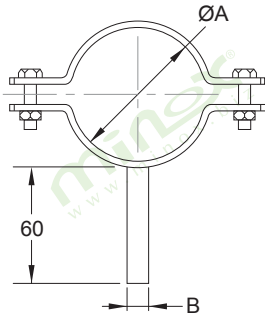

**Pipe Hanger A, without Groove Type
Dimension (mm)**

Size (Inch / DIN)	A	B
0.5"/10	12.7	8.0
0.75"/15	19.05	12.0
20	23.0	12.0
1.0"	25.4	12.0
25	29.0	12.0
32	35.0	12.0
1.5"	38.1	12.0
40	41.0	12.0
2.0"	50.8	12.0
50	53.0	12.0
2.5"	63.5	12.0
65	70.0	12.0
3.0"	76.2	12.0
3.5"	88.9	12.0
80	85.0	12.0
4.0" / 100	101.6	12.0
4.5"	114.3	12.0
5.0" / 125	129.0	12.0
5.5"	139.7	12.0
6.0" / 150	154.0	15.0
8.0" / 200	204.0	15.0
10.0" / 250	254.0	15.0
12.0" / 300	306.0	15.0

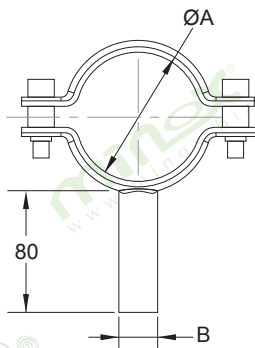

**Pipe Hanger B, 2 Bolts Type with Groove
Dimension (mm)**

Size (Inch / DIN)	A	B
0.5"/10	13.0	19.0
0.75"/15	19.0	19.0
20	23.0	19.0
1.0"/25	29.0	19.0
32	35.0	19.0
1.5" / 40	41.0	19.0
2.0" / 50	53.0	19.0
2.5"	63.5	19.0
65	70.0	19.0
3.0"	76.2	19.0
80	85.0	19.0
4.0" / 100	104.0	19.0
4.5"	114.3	19.0
125	129.0	19.0
150	154.0	19.0



Pipe Hanger

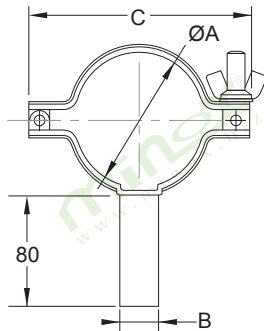

**Pipe Hanger C, Wing Nut Type with Groove
Dimension (mm)**

Size (Inch)	A	B	C
1.0"	25.4	19.0	66.0
1.5"	38.1	19.0	79.0
2.0"	50.8	19.0	90.0
2.5"	63.5	19.0	105.0
3.0"	76.2	19.0	120.0
4.0"	101.6	19.0	146.0



minox[®]