

Floating Valve

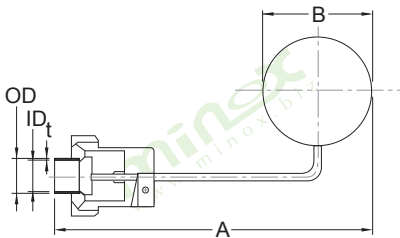

Product	: Floating Valve
Application	: To detect and maintain liquid level in a tank (15° angle detection)
Body Material	: Stainless Steel 304 & 316L
Rubber Material	: EPDM, Silicone & FKM/FPM
Working Pressure	: 3 bar
Size	: 1"



**Floating Valve
Dimension (mm)**

Size (Inch)	OD / ID x t	A	B
1.0"	25.4 / 22.4 x 1.5	535	200

Working Principles

