

Hygienic Screw Connections DIN 11853-1 (DIN)

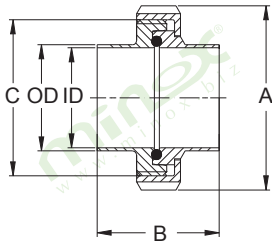

**Hygienic Screw Connection (DIN)
Dimension (mm)**

Size (DIN)	OD / ID x t	A	B	C
10	13.0 / 10.0 x 1.5	38	32	28 x 1/8
15	19.0 / 16.0 x 1.5	44	32	34 x 1/8
20	23.0 / 20.0 x 1.5	54	34	44 x 1/6
25	29.0 / 26.0 x 1.5	63	42	52 x 1/6
32	35.0 / 32.0 x 1.5	70	48	58 x 1/6
40	41.0 / 38.0 x 1.5	78	50	65 x 1/6
50	53.0 / 50.0 x 1.5	92	54	78 x 1/6
65	70.0 / 66.0 x 2.0	112	62	95 x 1/6
80	85.0 / 81.0 x 2.0	127	72	110 x 1/4
100	104.0 / 100.0 x 2.0	148	86	130 x 1/4

**Hygienic Screw Connection - Male Part (DIN)
Dimension (mm)**

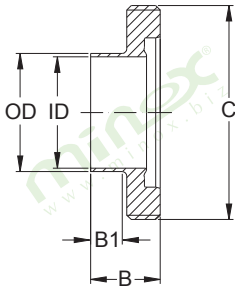

Size (DIN)	OD / ID x t	B	B1	C
10	13.0 / 10.0 x 1.5	19	5	28 x 1/8
15	19.0 / 16.0 x 1.5	19	5	34 x 1/8
20	23.0 / 20.0 x 1.5	21	5	44 x 1/6
25	29.0 / 26.0 x 1.5	26	10	52 x 1/6
32	35.0 / 32.0 x 1.5	30	14	58 x 1/6
40	41.0 / 38.0 x 1.5	31	15	65 x 1/6
50	53.0 / 50.0 x 1.5	31	15	78 x 1/6
65	70.0 / 66.0 x 2.0	36	16	95 x 1/6
80	85.0 / 81.0 x 2.0	42	18	110 x 1/4
100	104.0 / 100.0 x 2.0	50	26	130 x 1/4

**Hygienic Screw Connection - Liner (DIN)
Dimension (mm)**

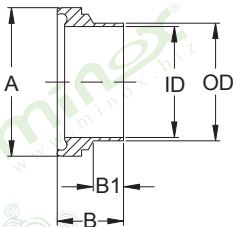

Size (DIN)	OD / ID x t	A	B	B1
10	13.0 / 10.0 x 1.5	21.9	17	5
15	19.0 / 16.0 x 1.5	27.9	17	5
20	23.0 / 20.0 x 1.5	35.9	18	5
25	29.0 / 26.0 x 1.5	42.9	22	8
32	35.0 / 32.0 x 1.5	48.9	25	10
40	41.0 / 38.0 x 1.5	54.9	26	10
50	53.0 / 50.0 x 1.5	66.9	30	13
65	70.0 / 66.0 x 2.0	84.9	34	15
80	85.0 / 81.0 x 2.0	98.9	38	15
100	104.0 / 100.0 x 2.0	118.9	46	23

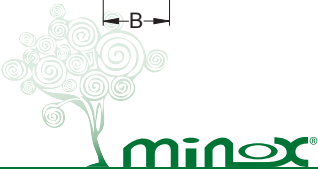

Hygienic Screw Connections DIN 11853-1 (DIN)

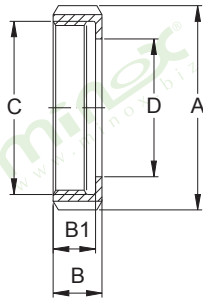

**Hygienic Screw Connection - Nut (DIN)
Dimension (mm)**

Size (DIN)	A	B	B1	C	D
10	38	18	15	28 x 1/8	19
15	44	18	15	34 x 1/8	25
20	54	20	17	44 x 1/6	31
25	63	21	18	52 x 1/6	36
32	70	21	18	58 x 1/6	42
40	78	21	18	65 x 1/6	49
50	92	22	19	78 x 1/6	62
65	112	25	21	95 x 1/6	80
80	127	29	25	110 x 1/4	94
100	148	31	26	130 x 1/4	115

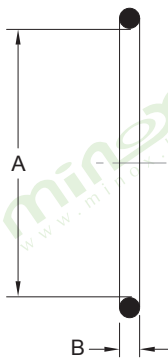

**Hygienic Screw Connection - Gasket (DIN)
Dimension (mm)**

Size (DIN)	A	B
10	12	3.5
15	18	3.5
20	22	3.5
25	28	3.5
32	34	5.0
40	40	5.0
50	52	5.0
65	68	5.0
80	83	5.0
100	102	5.0



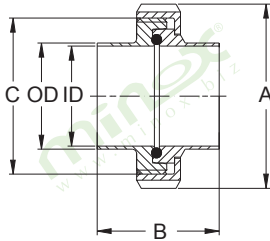

**Hygienic Screw Connection (Inch)
Dimension (mm)**

Size (Inch)	OD / ID x t	A	B	C
0.5"	12.70 / 9.40 x 1.65	38	32	28 x 1/8
0.75"	19.05 / 15.75 x 1.65	44	32	34 x 1/8
1.0"	25.40 / 22.10 x 1.65	63	42	52 x 1/6
1.5"	38.10 / 34.80 x 1.65	78	50	65 x 1/6
2.0"	50.80 / 47.50 x 1.65	92	54	78 x 1/6
2.5"	63.50 / 60.20 x 1.65	112	62	95 x 1/6
3.0"	76.20 / 72.90 x 1.65	127	72	110 x 1/4
4.0"	101.60 / 97.38 x 2.11	148	86	130 x 1/4

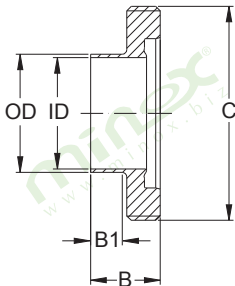

**Hygienic Screw Connection - Male Part (Inch)
Dimension (mm)**

Size (Inch)	OD / ID x t	B	B1	C
0.5"	12.70 / 9.40 x 1.65	19	5	28 x 1/8
0.75"	19.05 / 15.75 x 1.65	19	5	34 x 1/8
1.0"	25.40 / 22.10 x 1.65	26	10	52 x 1/6
1.5"	38.10 / 34.80 x 1.65	31	15	65 x 1/6
2.0"	50.80 / 47.50 x 1.65	31	15	78 x 1/6
2.5"	63.50 / 60.20 x 1.65	36	18	95 x 1/6
3.0"	76.20 / 72.90 x 1.65	42	18	110 x 1/4
4.0"	101.60 / 97.38 x 2.11	50	26	130 x 1/4

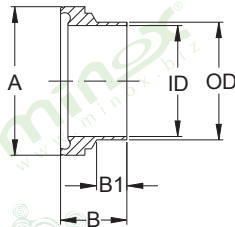

**Hygienic Screw Connection - Liner (Inch)
Dimension (mm)**

Size (Inch)	OD / ID x t	A	B	B1
0.5"	12.70 / 9.40 x 1.65	21.9	17	6.5
0.75"	19.05 / 15.75 x 1.65	27.9	17	6.5
1.0"	25.40 / 22.10 x 1.65	42.9	22	8.0
1.5"	38.10 / 34.80 x 1.65	54.9	26	9.5
2.0"	50.80 / 47.50 x 1.65	66.9	30	12.5
2.5"	63.50 / 60.20 x 1.65	84.9	34	21.0
3.0"	76.20 / 72.90 x 1.65	98.9	38	17.0
4.0"	101.60 / 97.38 x 2.11	118.9	46	21.0

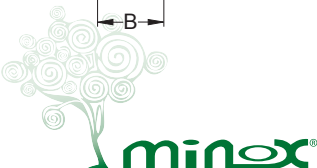



Hygienic Screw Connections

DIN 11853-1

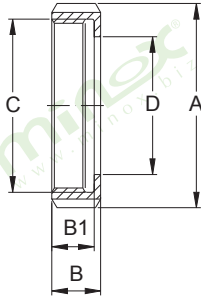

**Hygienic Screw Connection - Nut (Inch)
Dimension (mm)**

Size (Inch)	A	B	B1	C	D
0.5"	38	18	15	28 x 1/8	19
0.75"	44	18	15	34 x 1/8	25
1.0"	63	21	18	52 x 1/6	36
1.5"	78	21	18	65 x 1/6	49
2.0"	92	22	19	78 x 1/6	62
2.5"	112	25	21	95 x 1/6	80
3.0"	127	29	25	110 x 1/4	94
4.0"	148	31	26	130 x 1/4	115

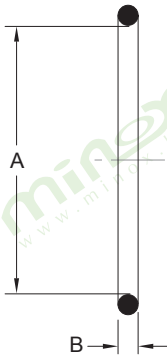

**Hygienic Screw Connection - Gasket (Inch)
Dimension (mm)**

Size (Inch)	A	B
0.5"	12	3.5
0.75"	18	3.5
1.0"	24	3.5
1.5"	37	5.0
2.0"	50	5.0
2.5"	62	5.0
3.0"	75	5.0
4.0"	100	5.0



Aseptic Screw Connections 11864-1 Form A (DIN)

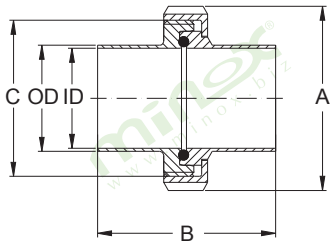

**Aseptic Screw Connection (DIN)
Dimension (mm)**

Size (DIN)	OD / ID x t	A	B	C
10	13.0 / 10.0 x 1.5	38	76	28 x 1/8
15	19.0 / 16.0 x 1.5	44	76	34 x 1/8
20	23.0 / 20.0 x 1.5	54	76	44 x 1/6
25	29.0 / 26.0 x 1.5	63	77	52 x 1/6
32	35.0 / 32.0 x 1.5	70	88	58 x 1/6
40	41.0 / 38.0 x 1.5	78	88	65 x 1/6
50	53.0 / 50.0 x 1.5	92	89	78 x 1/6
65	70.0 / 66.0 x 2.0	112	113	95 x 1/6
80	85.0 / 81.0 x 2.0	127	117	110 x 1/4
100	104.0 / 100.0 x 2.0	148	120	130 x 1/4

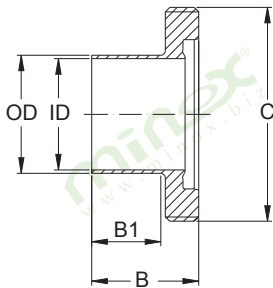

**Aseptic Screw Connection - Male Part (DIN)
Dimension (mm)**

Size (DIN)	OD / ID x t	B	B1	C
10	13.0 / 10.0 x 1.5	41	27	28 x 1/8
15	19.0 / 16.0 x 1.5	41	27	34 x 1/8
20	23.0 / 20.0 x 1.5	43	26	44 x 1/6
25	29.0 / 26.0 x 1.5	43	26	52 x 1/6
32	35.0 / 32.0 x 1.5	48	32	58 x 1/6
40	41.0 / 38.0 x 1.5	48	31	65 x 1/6
50	53.0 / 50.0 x 1.5	48	30	78 x 1/6
65	70.0 / 66.0 x 2.0	60	40	95 x 1/6
80	85.0 / 81.0 x 2.0	64	40	110 x 1/4
100	104.0 / 100.0 x 2.0	64	40	130 x 1/4

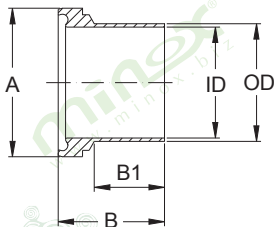

**Aseptic Screw Connection - Liner (DIN)
Dimension (mm)**

Size (DIN)	OD / ID x t	A	B	B1
10	13.0 / 10.0 x 1.5	21.9	39	27
15	19.0 / 16.0 x 1.5	27.9	39	27
20	23.0 / 20.0 x 1.5	35.9	38	26
25	29.0 / 26.0 x 1.5	42.9	40	26
32	35.0 / 32.0 x 1.5	48.9	47	32
40	41.0 / 38.0 x 1.5	54.9	47	31
50	53.0 / 50.0 x 1.5	66.9	48	30
65	70.0 / 66.0 x 2.0	84.9	61	40
80	85.0 / 81.0 x 2.0	98.9	61	40
100	104.0 / 100.0 x 2.0	118.9	66	40

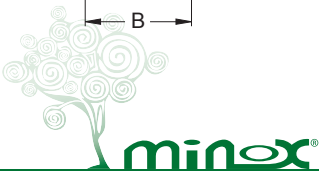

Aseptic Screw Connections 11864-1 Form A (DIN)

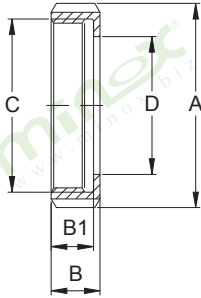

Aseptic Screw Connection - Nut (DIN)
Dimension (mm)

Size (DIN)	A	B	B1	C	D
10	38	18	15	28 x 1/8	19
15	44	18	15	34 x 1/8	25
20	54	20	17	44 x 1/6	31
25	63	21	18	52 x 1/6	36
32	70	21	18	58 x 1/6	42
40	78	21	18	65 x 1/6	49
50	92	22	19	78 x 1/6	62
65	112	25	21	95 x 1/6	80
80	127	29	25	110 x 1/4	94
100	148	31	26	130 x 1/4	115

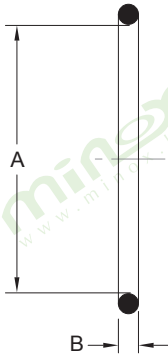

Aseptic Screw Connection - Gasket (DIN)
Dimension (mm)

Size (DIN)	A	B
10	12	3.5
15	18	3.5
20	22	3.5
25	28	3.5
32	34	5.0
40	40	5.0
50	52	5.0
65	68	5.0
80	83	5.0
100	102	5.0



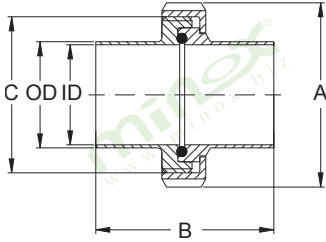

**Aseptic Screw Connection (Inch)
Dimension (mm)**

Size (Inch)	OD / ID x t	A	B	C
0.5"	12.70 / 9.40 x 1.65	38	76	28 x 1/8
0.75"	19.05 / 15.75 x 1.65	44	76	34 x 1/8
1.0"	25.40 / 22.10 x 1.65	63	77	52 x 1/6
1.5"	38.10 / 34.80 x 1.65	78	88	65 x 1/6
2.0"	50.80 / 47.50 x 1.65	92	89	78 x 1/6
2.5"	63.50 / 60.20 x 1.65	112	115	95 x 1/6
3.0"	76.20 / 72.90 x 1.65	127	117	110 x 1/4
4.0"	101.60 / 97.38 x 2.11	148	119	130 x 1/4

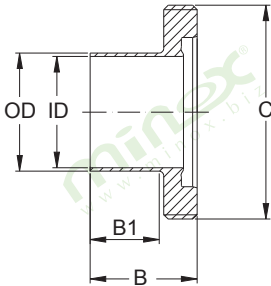

**Aseptic Screw Connection - Male Part (Inch)
Dimension (mm)**

Size (Inch)	OD / ID x t	B	B1	C
0.5"	12.70 / 9.40 x 1.65	41.0	27	28 x 1/8
0.75"	19.05 / 15.75 x 1.65	41.0	27	34 x 1/8
1.0"	25.40 / 22.10 x 1.65	43.0	26	52 x 1/6
1.5"	38.10 / 34.80 x 1.65	48.5	30	65 x 1/6
2.0"	50.80 / 47.50 x 1.65	48.5	30	78 x 1/6
2.5"	63.50 / 60.20 x 1.65	60.0	40	95 x 1/6
3.0"	76.20 / 72.90 x 1.65	64.0	40	110 x 1/4
4.0"	101.60 / 97.38 x 2.11	64.0	40	130 x 1/4

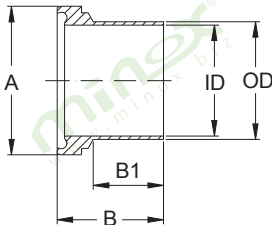

**Aseptic Screw Connection - Liner (Inch)
Dimension (mm)**

Size (Inch)	OD / ID x t	A	B	B1
0.5"	12.70 / 9.40 x 1.65	21.9	39.0	27
0.75"	19.05 / 15.75 x 1.65	27.9	39.0	27
1.0"	25.40 / 22.10 x 1.65	42.9	40.0	26
1.5"	38.10 / 34.80 x 1.65	54.9	46.5	30
2.0"	50.80 / 47.50 x 1.65	66.9	47.5	30
2.5"	63.50 / 60.20 x 1.65	84.9	63.0	40
3.0"	76.20 / 72.90 x 1.65	98.9	61.0	40
4.0"	101.60 / 97.38 x 2.11	118.9	65.0	40





Aseptic Screw Connections

11864-1 Form A

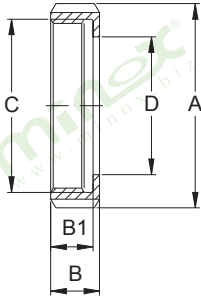

**Aseptic Screw Connection - Nut (Inch)
Dimension (mm)**

Size (Inch)	A	B	B1	C	D
0.5"	38	18	15	28 x 1/8	19
0.75"	44	18	15	34 x 1/8	25
1.0"	63	21	18	52 x 1/6	36
1.5"	78	21	18	65 x 1/6	49
2.0"	92	22	19	78 x 1/6	62
2.5"	112	25	21	95 x 1/6	80
3.0"	127	29	25	110 x 1/4	94
4.0"	148	31	26	130 x 1/4	115

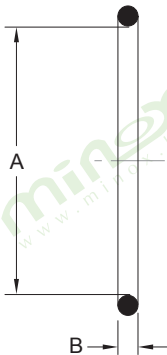

**Aseptic Screw Connection - Gasket (Inch)
Dimension (mm)**

Size (Inch)	A	B
0.5"	12	3.5
0.75"	18	3.5
1.0"	24	3.5
1.5"	37	5.0
2.0"	50	5.0
2.5"	62	5.0
3.0"	75	5.0
4.0"	100	5.0



DIN 11853-1 & DIN 11864-1 Form A Screw Connections (DIN)

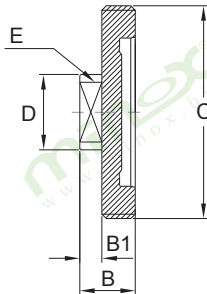

Screw Connection - Male Blank (DIN)
Dimension (mm)

Size (DIN)	B	B1	C	D	E
10	24	12	28 x 1/8	22	17
15	24	12	34 x 1/8	22	17
20	24	10	44 x 1/6	22	17
25	24	10	52 x 1/6	40	27
32	24	10	58 x 1/6	40	27
40	24	10	65 x 1/6	40	27
50	24	10	78 x 1/6	40	27
65	28	12	95 x 1/6	48	32
80	28	8	110 x 1/4	48	32
100	30	10	130 x 1/4	48	32

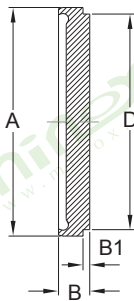

Screw Connection - Liner Blank (DIN)
Dimension (mm)

Size (DIN)	A	B	B1	D
10	21.9	9	3	18
15	27.9	9	3	24
20	35.9	10	3	30
25	42.9	12	3	35
32	48.9	13	3	41
40	54.9	13	3	48
50	66.9	14	3	61
65	84.9	16	4	79
80	98.9	16	4	93
100	118.9	20	5	114



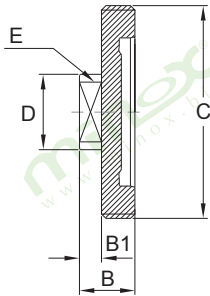

**Screw Connection - Male Blank (Inch)
Dimension (mm)**

Size (Inch)	B	B1	C	D	E
0.5"	24	12	28 x 1/8	22	17
0.75"	24	12	34 x 1/8	22	17
1.0"	24	10	52 x 1/6	40	27
1.5"	24	10	65 x 1/6	40	27
2.0"	24	10	78 x 1/6	40	27
2.5"	28	12	95 x 1/6	48	32
3.0"	28	12	110 x 1/4	48	32
4.0"	30	10	130 x 1/4	48	32

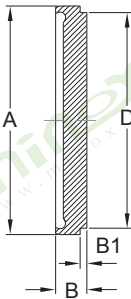

**Screw Connection - Liner Blank (Inch)
Dimension (mm)**

Size (Inch)	A	B	B1	D
0.5"	21.9	9	3	18
0.75"	27.9	9	3	24
1.0"	42.9	12	3	35
1.5"	54.9	13	3	48
2.0"	66.9	14	3	61
2.5"	84.9	16	4	79
3.0"	98.9	16	4	93
4.0"	118.9	20	5	114